

COFFEE PLAZA

East

HAFENCITY

CLICK 

A PEMBROKE PROPERTY

Welcome to

COFFEE PLAZA EAST

Coffee Plaza East is part of HafenCity's vibrant neighbourhood on the waterfront.

Perfectly located on Am Sandtorpark the unit benefits from dual frontage with enviable views of the lush green park and Elbphilharmonie.

RETAIL OPPORTUNITY



Designed

WITH PEOPLE IN MIND

With cafes, hotels and brasseries on the doorstep, Coffee Plaza East is part of a carefully curated mix of amenities for the nearby office workers, tourists and residents.

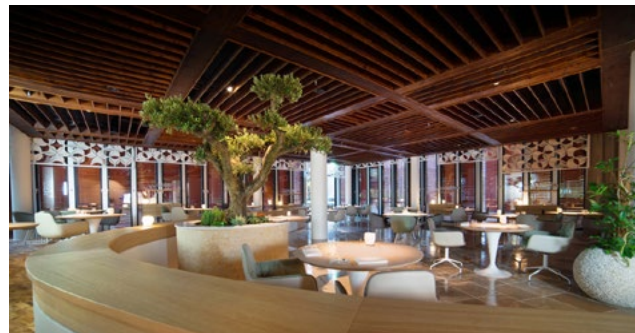

THE *Opportunity* DESTINATIONAL

317 SQ M

OPPORTUNITY FOR
OUTSIDE SEATING

DUAL ENTRY

FLOOR TO CEILING
GLAZING



THE *Opportunity* DESTINATIONAL

OPPORTUNITY FOR
OUTSIDE SEATING

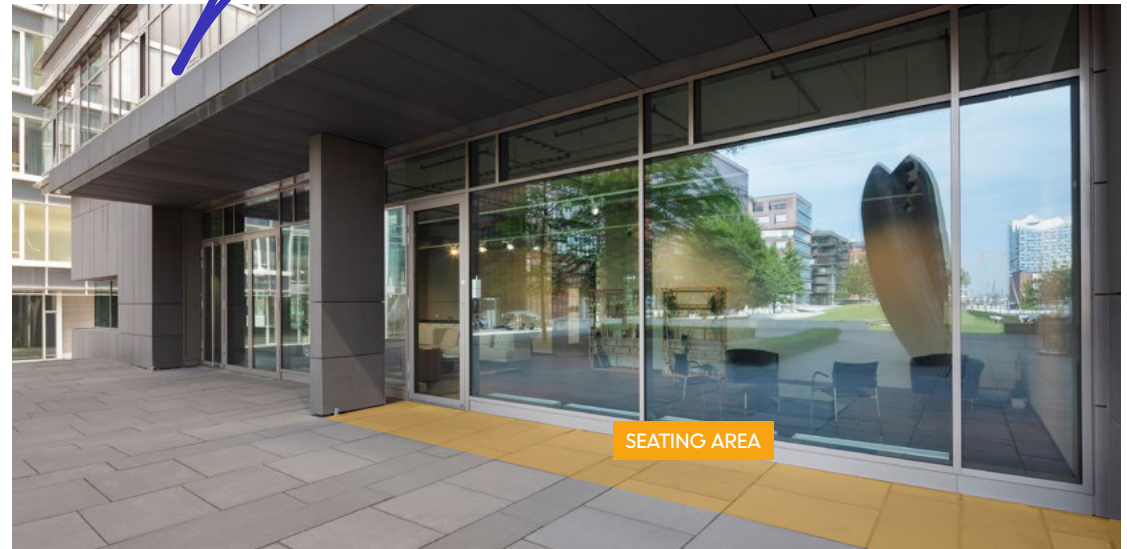

THE *Opportunity* DESTINATIONAL



THE Opportunity DESTINATIONAL



THE Opportunity

GRAB & GO

150 SQ M

OPPORTUNITY FOR
OUTSIDE SEATING

DUAL ENTRY

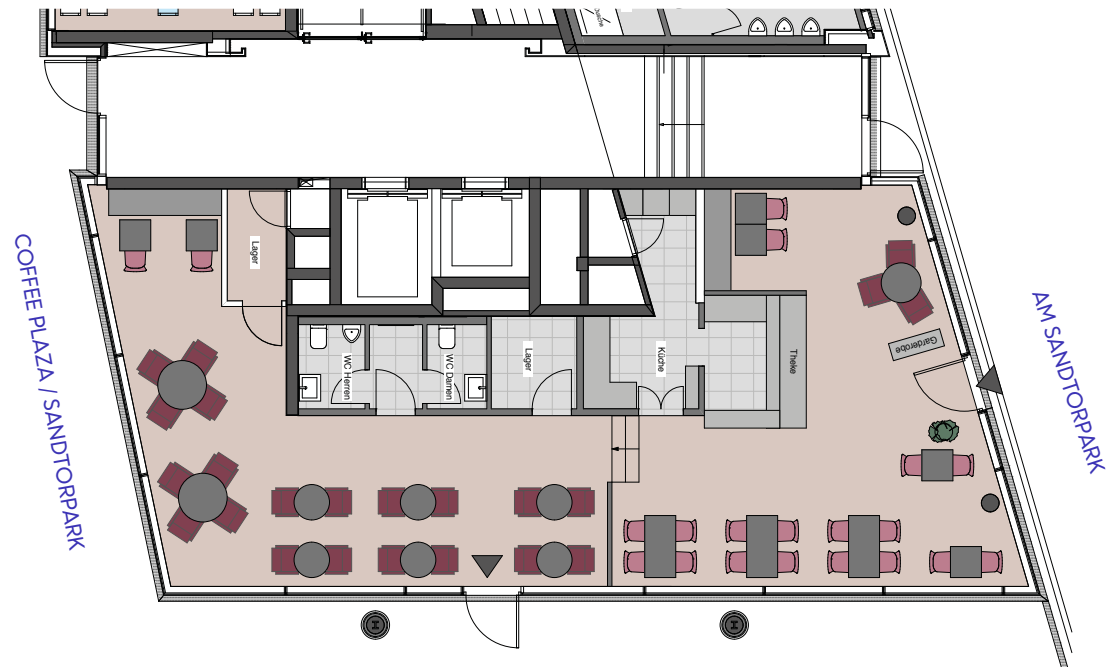
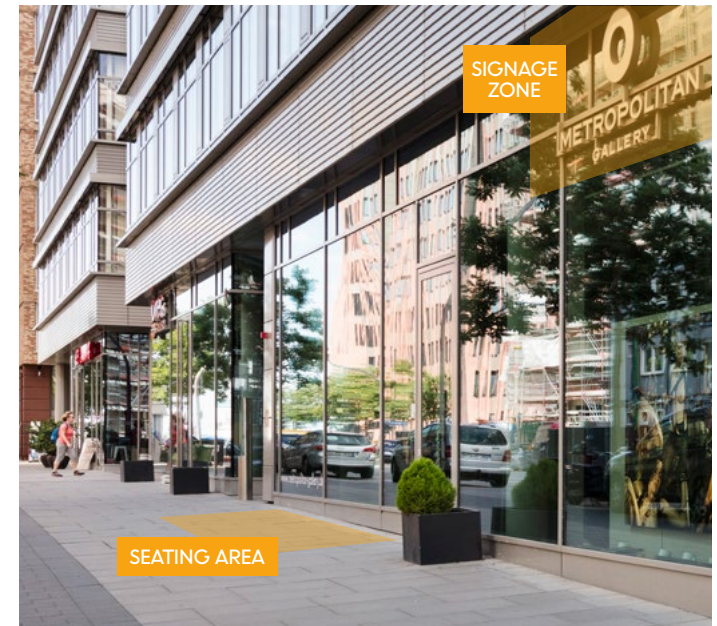
FLOOR TO CEILING
GLAZING

THE *Opportunity* GRAB & GO

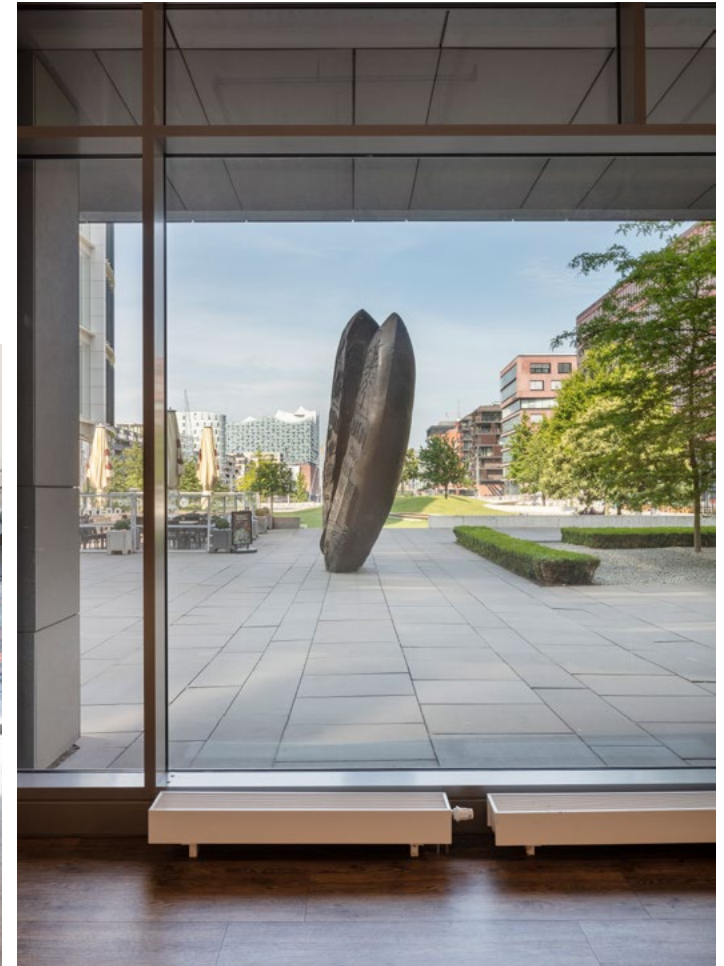

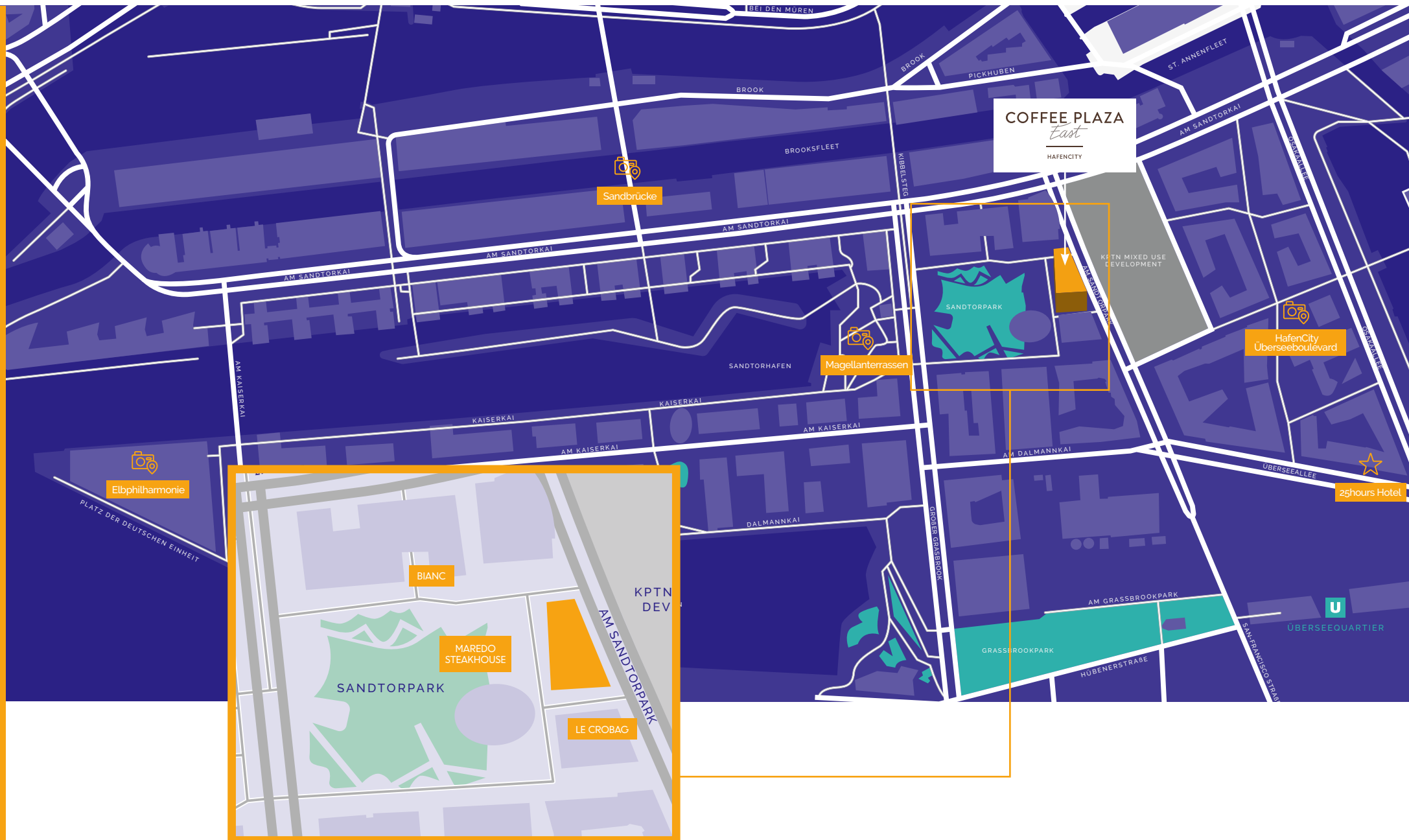

Thoughtful PROPERTY

We're an international real estate advisor that acquires, develops and manages properties and places - specializing in mixed-use and office environments in the world's leading cities. We have offices in Boston, London, Munich, Stockholm, Sydney, Tokyo, and Washington DC, and manage approximately 802,000 sq m/ 8.6m sq ft in North America, Europe, and Asia Pacific. By combining a global point of view with local expertise, we're able to create and manage world-class properties that deliver the best outcomes for our tenants, investors and the communities in which we work.



CHRISTIAN BOSILJANOFF
Director of Asset Management,
Germany

